



THE ELVES AND THE SHOEMAKER CRAFTING

Creative fun!

Using everyday items found in the home, find your inner creative by making a shoemaker's shop scene including a sparkly cone tree and making your very own personalised elf. Colour in some shoes and leave them for the naughty elf to report back to Santa.



EQUIPMENT REQUIRED

- A4 printer & paper
- Large empty cereal box
- Scissors
- Glue & sticky tape
- Pens/pencils or paint to colour in
- Tin foil
- Cotton wool
- 1 photograph of yourself



CONTENTS

Five pages to print / colour in and cut out
Easy written instructions with photographs

INSTRUCTIONS

INSTRUCTION 1

Carefully open the cereal box and lay flat as in photograph 1.



INSTRUCTION 2

Cut away the top and bottom pieces where the arrows are pointing in photograph 2 and keep one of them for the elf later.



INSTRUCTION 3

Print out the A4 wooden floor and shop scene as shown in photograph 3.
Colour in the shop scene.



INSTRUCTION 4

Glue and stick the wooden floor printout and coloured shop picture to the cereal packaging as shown in photograph 4.



INSTRUCTION 5

Glue the area of cereal packaging as shown in photograph 5 and fold the shop scene forward so that it sticks to the area glued and forms a stand as in photograph 6. Fold back the sides of the cereal packaging and tape to the bottom pieces on both sides as in photograph 6.

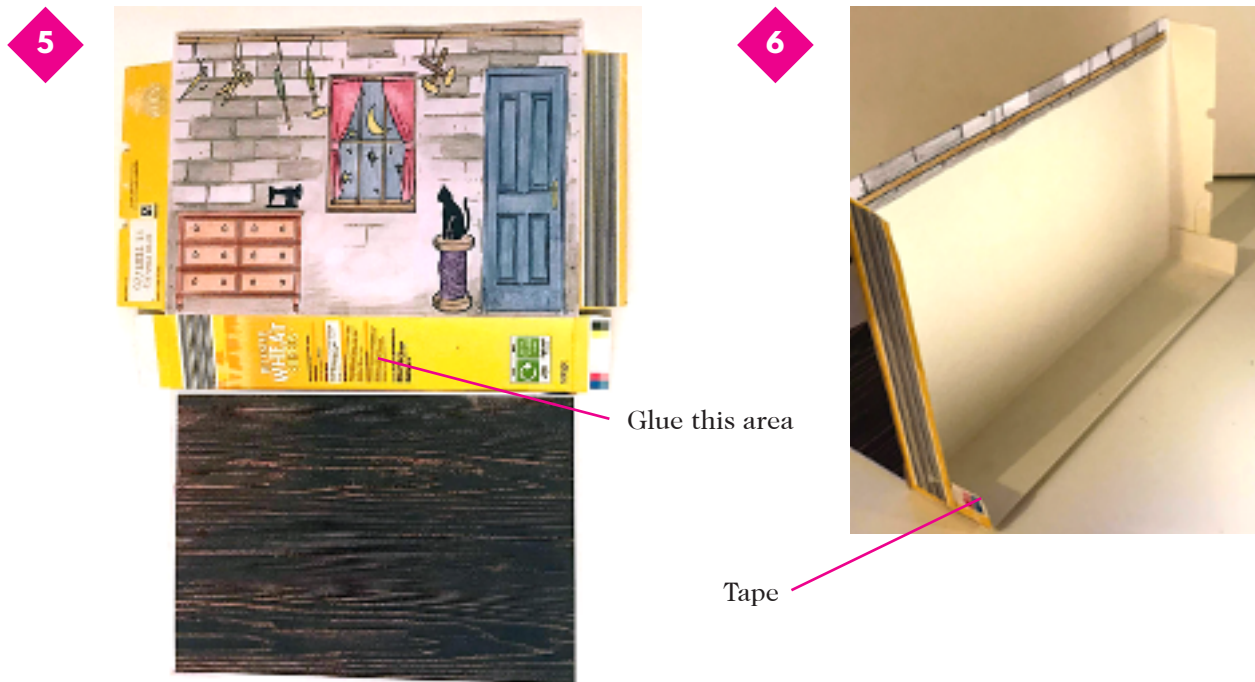

INSTRUCTION 6

Colour in and cut out the cone tree. Fold the printout into a cone and stick the neat edge over the tab edge as shown in photograph 7. Make small silver baubles from crumpled up tin foil and stick to the tree.

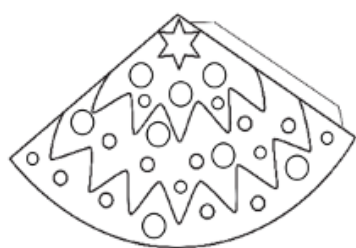

INSTRUCTION 7

Cut out a photograph of your face and stick to the elf. Cut out the elf. Colour in the elves clothes and cut out. Stick the clothes to the elf. Glue some cotton wool to the hat.

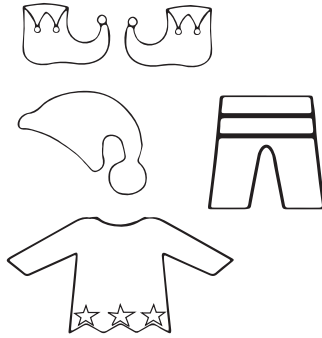
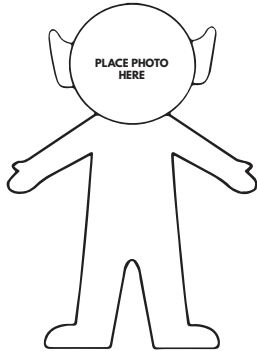

Stick the strip of cereal packaging that you cut away earlier to the elf and fold the bottom as in photograph 8. When placing the elf in front of the shop scene stick this folded part to the floor to keep the elf upright.

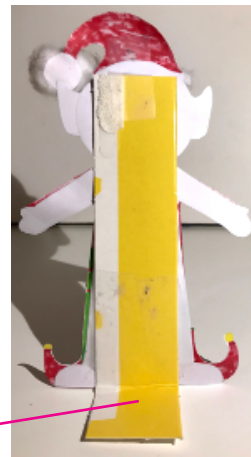

Fold back

8

INSTRUCTION 8

Now have fun colouring in the shoes and leave them out at night for the naughty elves to have a look at and report back to Santa.





